

# Soils Map

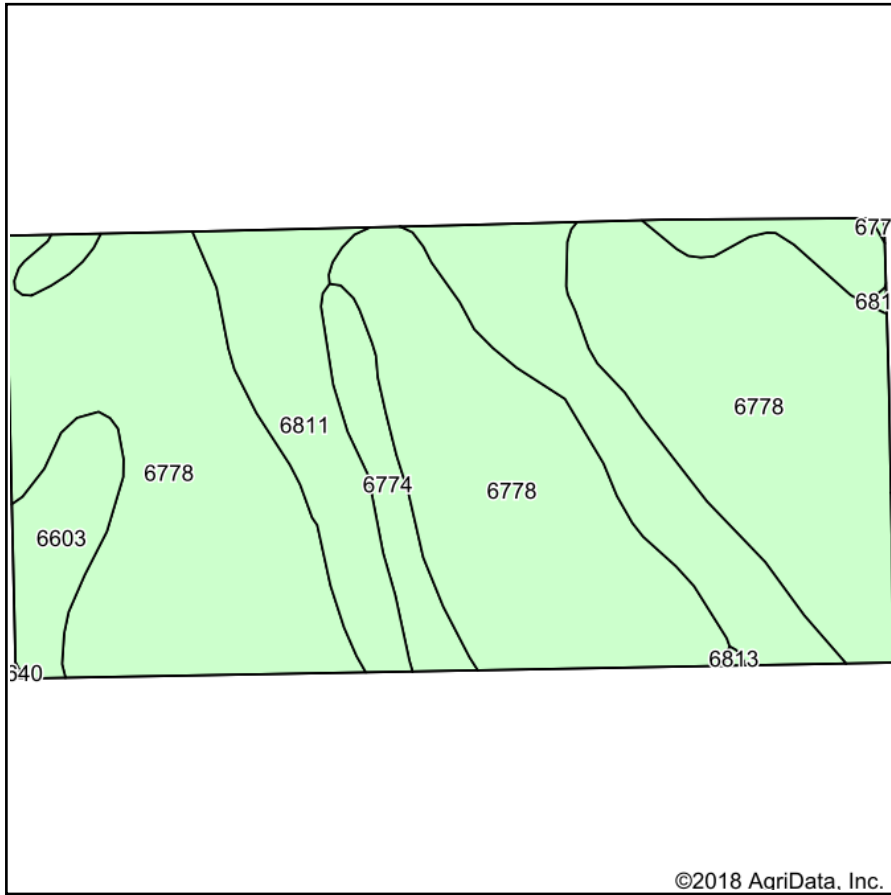

Soils data provided by USDA and NRCS.

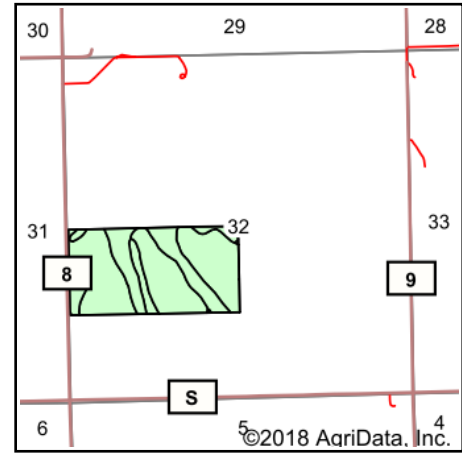

State: **Nebraska**  
 County: **Colfax**  
 Location: **32-20N-3E**  
 Township: **Adams**  
 Acres: **79.28**  
 Date: **10/30/2018**

 **The Pinnacle Agency**  
 FARM MANAGEMENT-REAL ESTATE

Maps Provided By:  
  
 CUSTOMIZED ONLINE MAPPING  
 © AgriData, Inc. 2018 www.AgriDataInc.com



## Area Symbol: NE037, Soil Area Version: 17

Code	Soil Description	Acres	Percent of field	Non-Irr Class *c	Irr Class *c	SRPG	Alfalfa hay	Cool season grasses	Corn	Grain sorghum	Soybeans	Winter wheat	*n NCCPI Soybeans
6778	Nora-Crofton complex, 6 to 11 percent slopes, eroded	53.83	67.9%	IIIe	IVe	60							62
6811	Moody silty clay loam, 2 to 6 percent slopes	18.40	23.2%	Ile	IIIe	73							73
6603	Alcester silty clay loam, 2 to 6 percent slopes	3.70	4.7%	Ile	IIIe	73							70
6774	Nora-Crofton complex, 11 to 17 percent slopes, eroded	3.35	4.2%	IVe		54							57
<b>Weighted Average</b>						<b>63.4</b>	<b>*-</b>	<b>*-</b>	<b>*-</b>	<b>*-</b>	<b>*-</b>	<b>*-</b>	<b>*n 64.7</b>

\*n: The aggregation method is "Weighted Average using major components"

\*c: Using Capabilities Class Dominant Condition Aggregation Method

Soils data provided by USDA and NRCS.